

**NEW
PUBLIX
LOCATION**

VAUGHN ROAD
AND
PIKE ROAD
Pike Road, Alabama
THE TROTMAN
COMPANY, INC.

PRINTED: 10/8/2020 @ 3:57PM

FILE NAME: C:\Users\scherron\AppData\Local\Temp\AcPublish_15256\LEASING PLAN.dwg

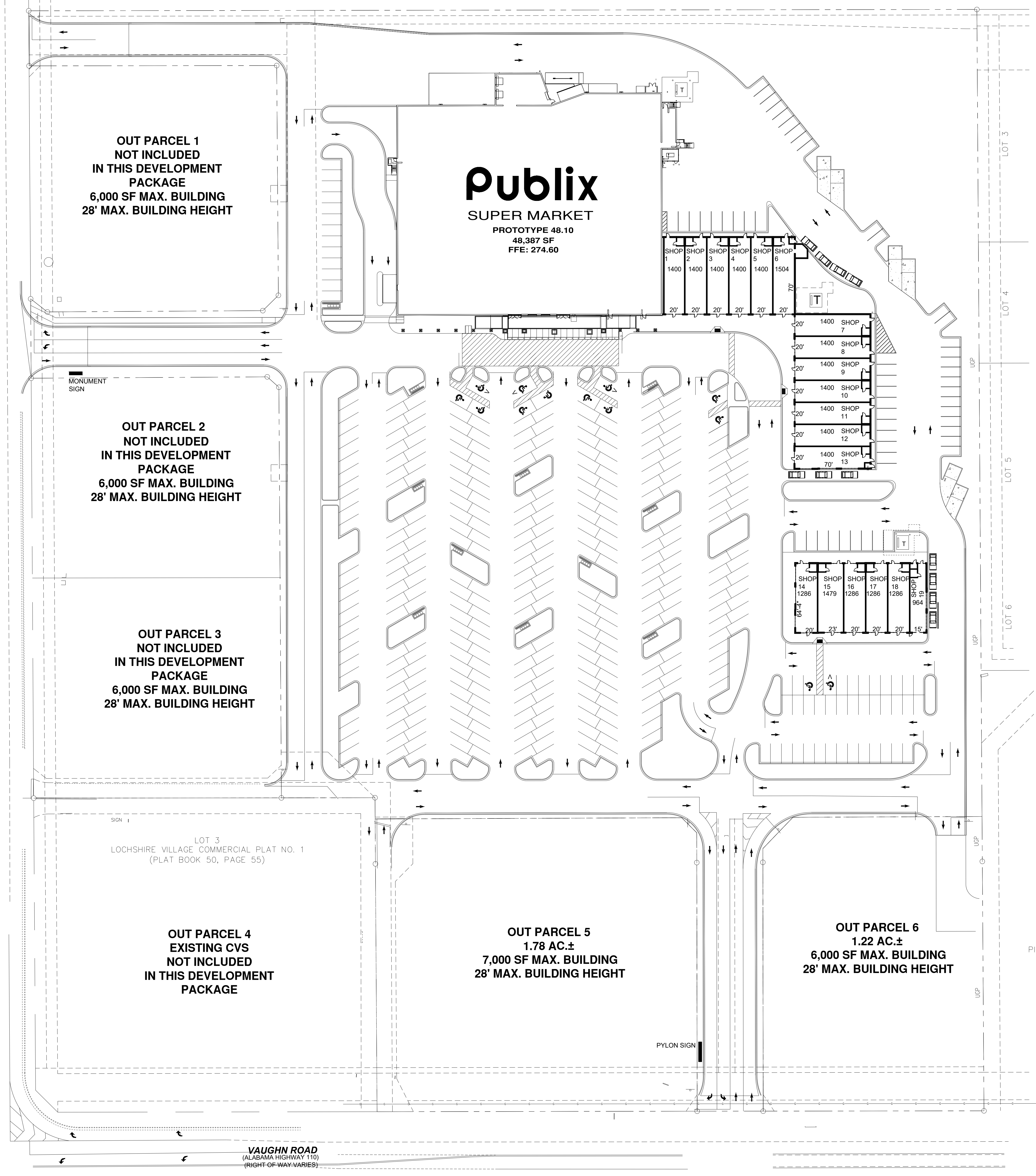

**OUT PARCEL 1
NOT INCLUDED
IN THIS DEVELOPMENT
PACKAGE
6,000 SF MAX. BUILDING
28' MAX. BUILDING HEIGHT**

**OUT PARCEL 2
NOT INCLUDED
IN THIS DEVELOPMENT
PACKAGE
6,000 SF MAX. BUILDING
28' MAX. BUILDING HEIGHT**

**OUT PARCEL 3
NOT INCLUDED
IN THIS DEVELOPMENT
PACKAGE
6,000 SF MAX. BUILDING
28' MAX. BUILDING HEIGHT**

**OUT PARCEL 4
EXISTING CVS
NOT INCLUDED
IN THIS DEVELOPMENT
PACKAGE**

**OUT PARCEL 5
1.78 AC.±
7,000 SF MAX. BUILDING
28' MAX. BUILDING HEIGHT**

**OUT PARCEL 6
1.22 AC.±
6,000 SF MAX. BUILDING
28' MAX. BUILDING HEIGHT**

LOT 3
LOCHSHIRE VILLAGE COMMERCIAL PLAT NO. 1
(PLAT BOOK 50, PAGE 55)

LOT 1
PIKE ROAD STATION PLAT NO. 1
(PLAT BOOK 50, PAGE 123)

LOCHSHIRE PLAT NO. 5
(PLAT BOOK 51, PAGE 77)

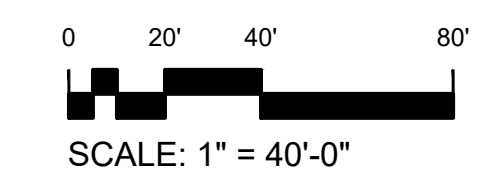

LEASING PLAN
SCALE: 1" = 40'

Project Number: 18-731
Date: 29 JUNE 2020
Revisions:

Sheet Description

LEASING PLAN

Sheet Number

LP1.0